

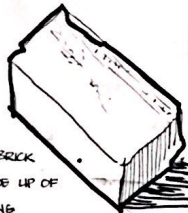

THE BRICK IS MADE UP OF COWDUNG

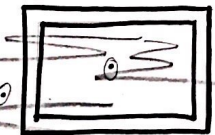

THE BAATIS ARE HARD ON THE OUTSIDE AND SOFT ON THE INSIDE



THE PRODUCER OF THE BAATI REPRESENTS THE CORE OF IT, WHERE ALL THE MAJOR FLAVOURS OF THE BAATI ARE PRESENT.

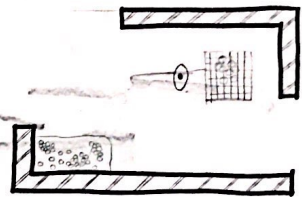

## SCHEMATIC PLAN

## ABOUT

THE INSTALLATION IS SUPPOSE TO GIVE AN ESSENCE OF THE PROCESS AND SHOWING HOW IMPORTANT THE PRODUCER IS.

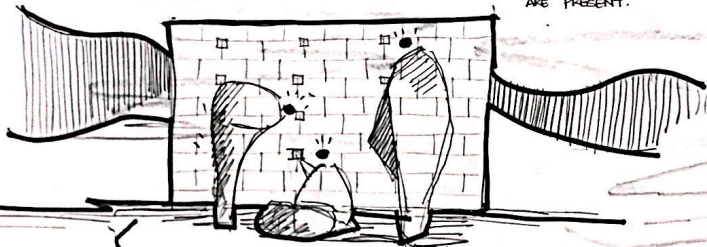

THE BAATI BELONGS TO THE WALL



SILHOUETTE OF THE BAATI LETTING LIGHT SEEP IN.



VIEWS CREATED IN THE OPENINGS

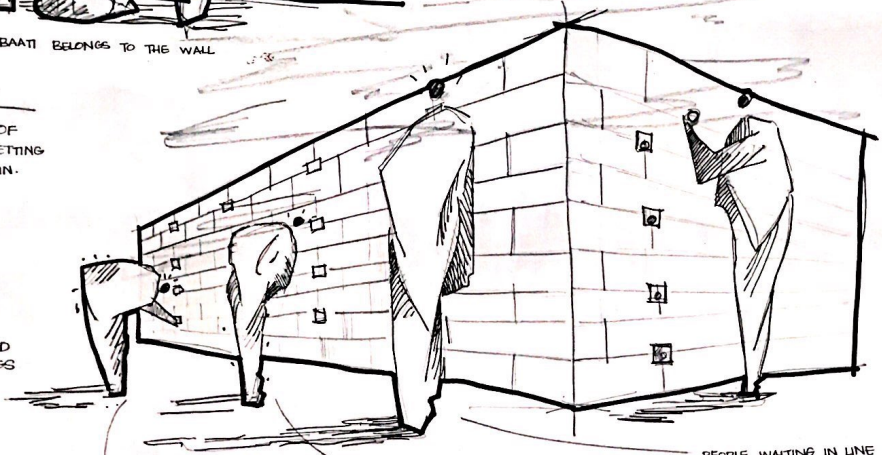

PEOPLE PICKING UP BAATIS TO EAT

PEOPLE PEEKING IN TO LOOK AT THE PROCESS.

PEOPLE WAITING IN LINE TO GET SERVED.